

GALAX

INSTALLATION MANUAL

Explosive view

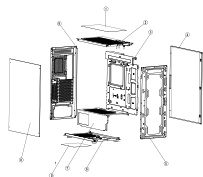

- ① Dust filter ② Top panel ③ M/B ④ Right side panel ⑤ Front plate
⑥ Bottom plate ⑦ PSU cover ⑧ Left tempered glass side panel
⑨ Rear panel ⑩ Dust filter on the bottom

PSU installation

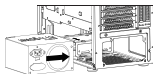

Put PSU into chassis from left side

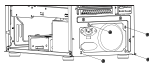

Lock 4pcs PSU screws to fix PSU

M/B installation

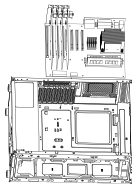

Put M/B to chassis on right position and fix screws

HDD installation



Loosen 2pcs screws for HDD bracket, pull out HDD bracket



Fix HDD on bracket



SSD installation
Firstly place SSD on top of bracket as shown above and lock screws; then insert HDD inside.

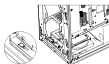

Put bracket on chassis after HDD installation, and lock 2pcs screws

SSD installation

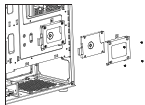

Take off SSD bracket, then fix SSD on bracket and lock bracket to previous place

Fan and Water cooling installation

Install fan and water cooling on top panel

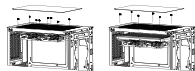

Put fan or water cooling on top panel from inner side and fix screws from outside

Install fan and water cooling on front plate

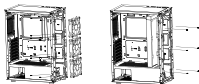

Put fan or water cooling on front plate from inner side and fix screws from outside

Install fan and water cooling on rear panel

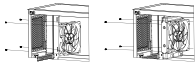

Put fan or water cooling on rear plate from inner side and fix screws from outside

Install fan on PSU cover



Put fan on upside of PSU cover and fix screws

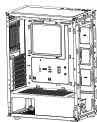

Place VGA card on M/B and adjust the height accordingly, then insert the 2pcs screws to fix in place.

Install side panel

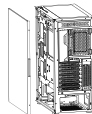

Put side panel on right position and push it, then lock 2pcs screws

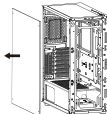

Open left side panel and remove the tempered glass side panel